

A PROJECT BY  
**CHAKOR**  
VENTURES

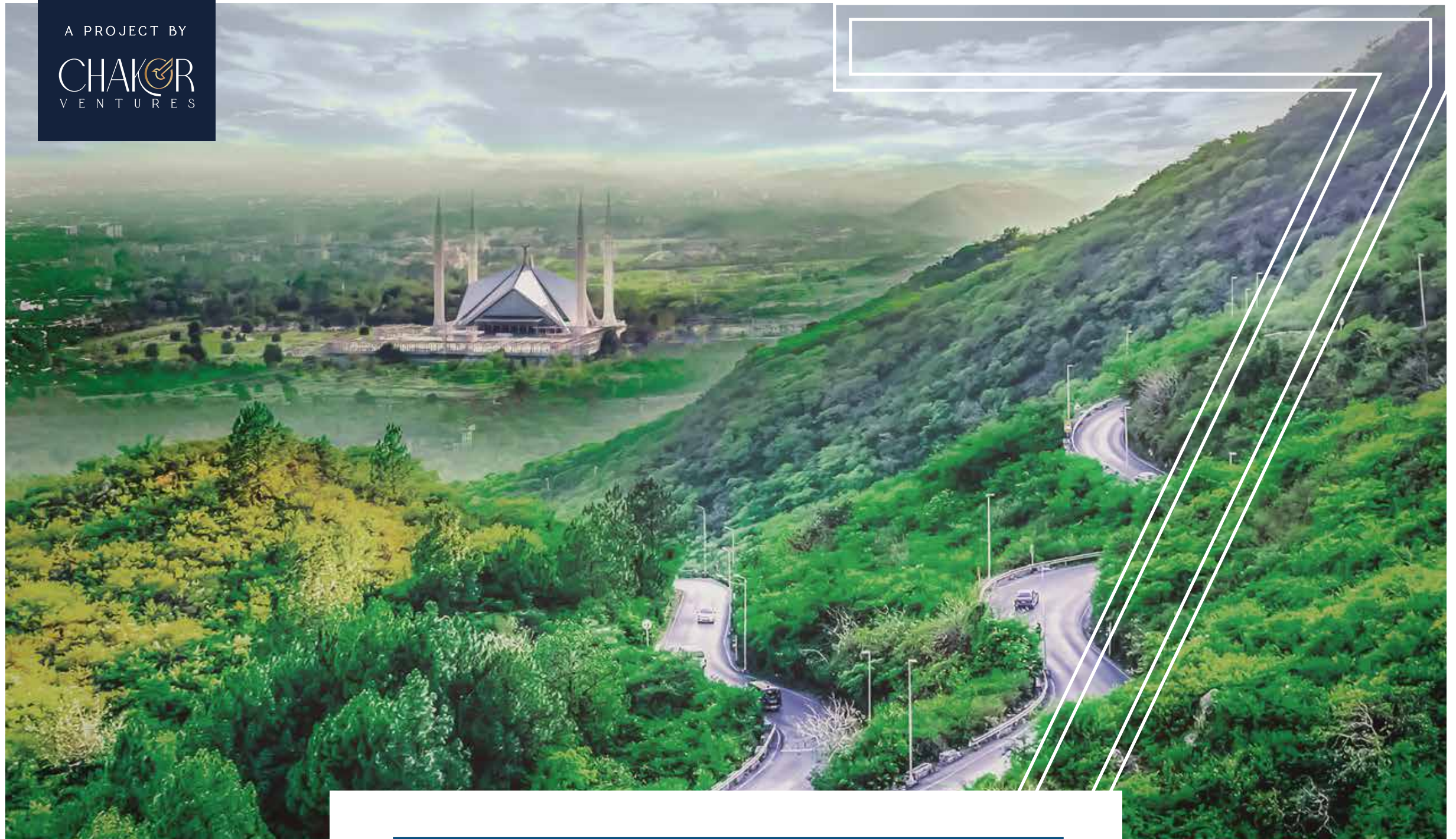

# CITADEL 7

A PROJECT BY

CHAKOR

VENTURES

CITADEL





CHAKOR  
VENTURES

## ACHIEVING HEIGHTS

We are an emerging development enterprise with expertise in architectural planning, real estate development, investment consultancy and facility management. We integrate innovative technology and smart solutions into our business model with an aim to revolutionize the high-rise real-estate industry in Pakistan.





## T A B L E O F C O N T E N T

<b>About Chakor Ventures</b>	<b>1 – 08</b>
<ul style="list-style-type: none"><li>• Our Core Values</li><li>• Our Vision &amp; Mission</li><li>• President's Message</li><li>• General Manager's Message</li></ul>	
<b>Introducing Citadel 7</b>	<b>09 – 13</b>
<b>Citadel 7: Overview</b>	<b>14 – 18</b>
<ul style="list-style-type: none"><li>• Architecture Structure</li><li>• Location</li></ul>	
<b>Office Spaces</b>	<b>19 – 26</b>
<ul style="list-style-type: none"><li>• Lobby Area</li><li>• Office Floor Plan</li><li>• Service Floor</li></ul>	
<b>Retail Mall &amp; Food Court</b>	<b>27 – 40</b>
<ul style="list-style-type: none"><li>• Café &amp; Restaurant</li><li>• Mall Outlets</li><li>• Retail Mall &amp; Food Court Floor Plans</li></ul>	
<b>Parking</b>	<b>41 – 42</b>
<b>Views from Citadel 7</b>	<b>43 – 46</b>



# OUR CORE VALUES



## PASSION

Positive impact through unwavered candor

## COMPETENCE

Ownership driven by Initiative & Leadership

## INTEGRITY

Built upon Dignity, Trust & Transparency

## SUSTAINABILITY

Focused on creating a better future for all





## OUR **VISION**

Chakor Ventures has a unique vision to create exquisite and diverse commercial space with world-class projects in line. Our constant endeavors are to develop a state-of-the-art and innovative infrastructure.



## OUR **MISSION**

Our aim is to economically empower individuals and creatively enhance our communities through innovative infrastructure development. Our aspiration is to solve the challenges of our growing community while keeping in mind the critical economic and environmental challenges. We strive to make a better tomorrow for our nation and contribute in furthering our country's progress.



“

## MESSAGE FROM THE **PRESIDENT**

We at Chakor Ventures firmly believe in the principles of inspiration and hard work. The embodiment of success takes hold when one takes inspiration from the past and uses it to manifest glory. Since our inception, we have been committed to bringing forth highly affordable, sustainable, and reliable services that render a solely customer-first approach.

WE CONSTRUCT TO PROVE THAT ARCHITECTURE  
CAN BE A SOURCE OF MARVEL.

**MUHAMMAD ASAD KHAN**

**PRESIDENT**  
CHAKOR VENTURES

“

## MESSAGE FROM THE **GENERAL MANAGER**

We emerge into the industry well-competent and capable by using our industry knowledge, skills, and expertise to open up new horizons of glorious development while promoting growth with investment. We take full responsibility for developing and empowering our resources by taking ownership of our relationships with our partners.

CHAKOR STAUNCHLY FOLLOWS INTEGRITY  
AND DISCIPLINE IN ITS BUSINESS MODULE OF  
VERTICAL CONSTRUCTION.

**OMER KHITAB**

**GENERAL MANAGER**  
CHAKOR VENTURES

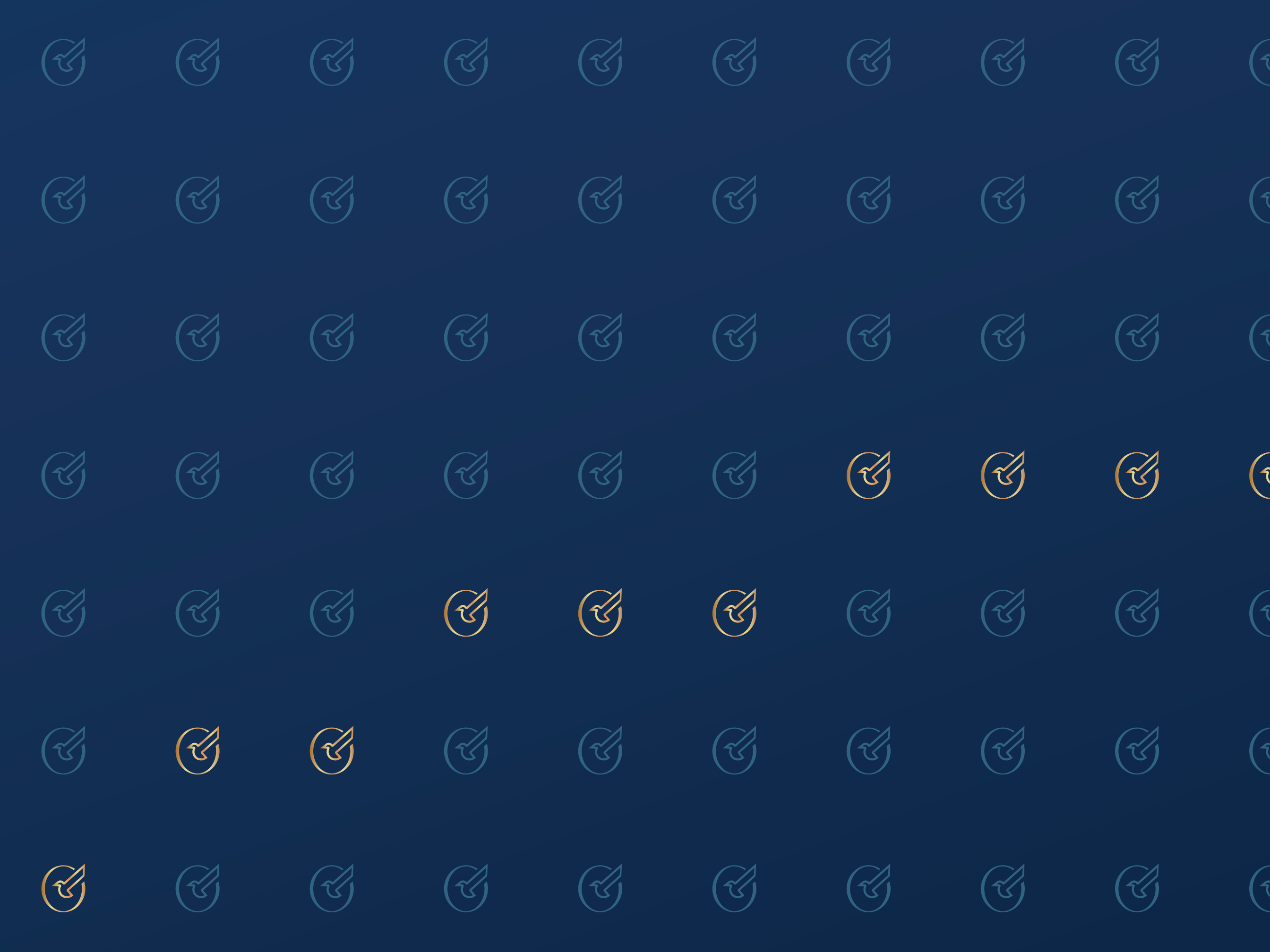





I N T R O D U C I N G

# CITADEL7

A modern and unique edifice that meets the growing demands of urban architecture and reimagines the fabric of our great city, **Citadel 7** is Chakor Venture's state-of-the-art commercial project that is ahead of its time. It is a contemporary embodiment of luxury and practicality.

**Citadel 7** envisions an urban spectacular of leisure and corporation together. Immerse into an unparalleled experience with offices, retail-mall, culinary hub, and entertainment — all within your reach.



REDEFINING



GRANDEUR





# RISE FROM THE DEPTHS; **SOAR TO GREAT HEIGHTS**

An outstanding **20-storey** high architecture encompassing 5 levels of lavishly designed retail space and 14 floors of luxurious corporate offices. **Citadel 7** is inaugurated with all the latest facilities and the best of amenities that are innovative, convenient, and secure at its core.



## ARCHITECTURE STRUCTURE

# THE 20 STORIES OF CITADEL

We aim to deliver a project that is not just well built, but also well managed. Comprising 4 floors of the latest retail mall, an expansive food court & dining area, and 14 floors of luxurious corporate offices.

**Immerse into a grand experience with Citadel 7.**

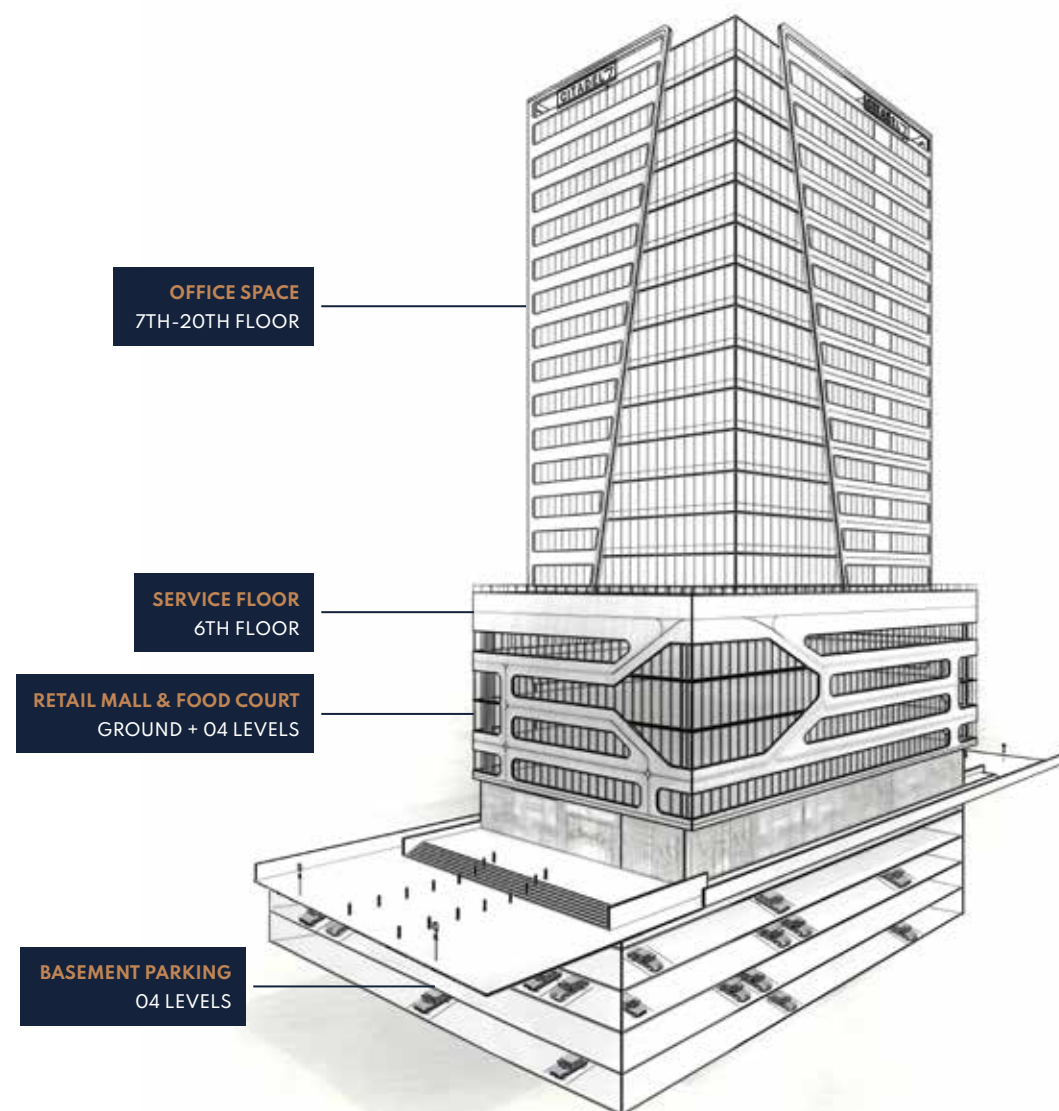



# POSSIBILITIES WITHIN YOUR REACH

Ideally situated in the most happening area of Islamabad.

## A CONVENIENT COMMUTE

0 Minutes BLUE AREA	0 Minutes METRO STATION
1 Minute PIMS	3 Minutes F 9 PARK
5 Minutes FAISAL MOSQUE	5 Minutes PAKISTAN MONUMENT
10 Minutes DIPLOMATIC ENCLAVE	25 Minutes M2
40 Minutes ISLAMABAD AIRPORT	



### MAP LEGEND

- Citadel 7
- Nearby Places
- Nearby Restaurants
- Nearby Metro Stations



MARGALLA HILLS



FAISAL MOSQUE



F-7

F-8

G-7

G-8

G-9



CENTAURUS MALL



CITADEL 7



NADRA MEGA CENTER



PIMS



PAKISTAN MONUMENT



Metro Station



Metro Station



Metro Station



Savour Foods



McDonald's



FATIMA JINNAH PARK (F-9 PARK)



Main Margalla Rd

Main Margalla Rd

Main Margalla Rd

Faisal Ave

Faisal Ave

Bhittai Rd

Marvi Rd

7th Ave

7th Ave

Luzman Hakeem Rd

Srinagar Highway

Srinagar Highway

Srinagar Highway

9th Ave

Park Rd

Nizam-ud-din Rd

Jinnah Ave

Jinnah Ave

Jinnah Ave

Jinnah Ave

Ibn-e-Sina Rd

Ibn-e-Sina Rd

9th Ave

Hanna Rd

Shah Abdul Latif Rd



# ENTER THE WORLD OF CITADEL





CITADEL7





## OFFICE SPACES

# REIMAGINE YOUR WORKPLACE

Accelerate with our grand offices starting from the 7th floor of **Citadel 7** all the way to the 20th floor.

Our offices feature opulent conference rooms, co-working spaces, executive suites, and centralized atriums that keep you motivated while you work.



Dedicated & Monitored Entrance



Exclusive High-Speed Elevators



Extravagant Lobbies with  
Centralized Atrium



Separate Waiting Area





# INNOVATIVE & CONTEMPORARY ARCHITECTURE

A semblance of innovation and timeless architecture



Workspace with a View



Dedicated Parking Space



Direct Access to the Food Court & Mall



## LOBBY AREA

# AWAITING A **WARM WELCOME**

Staying faithful to Islamabad's vernacular, on the 11th floor of **Citadel 7**, we offer a magnificent open-to-sky courtyard that serves as a lounging area for you and your guests. Enjoy the natural daylight and de-stress without leaving the building owing to our modular centralized atriums.

This grand lobby area has an adequate seating arrangement, a mini café, and a lounging area that opens gates to a relishing experience.



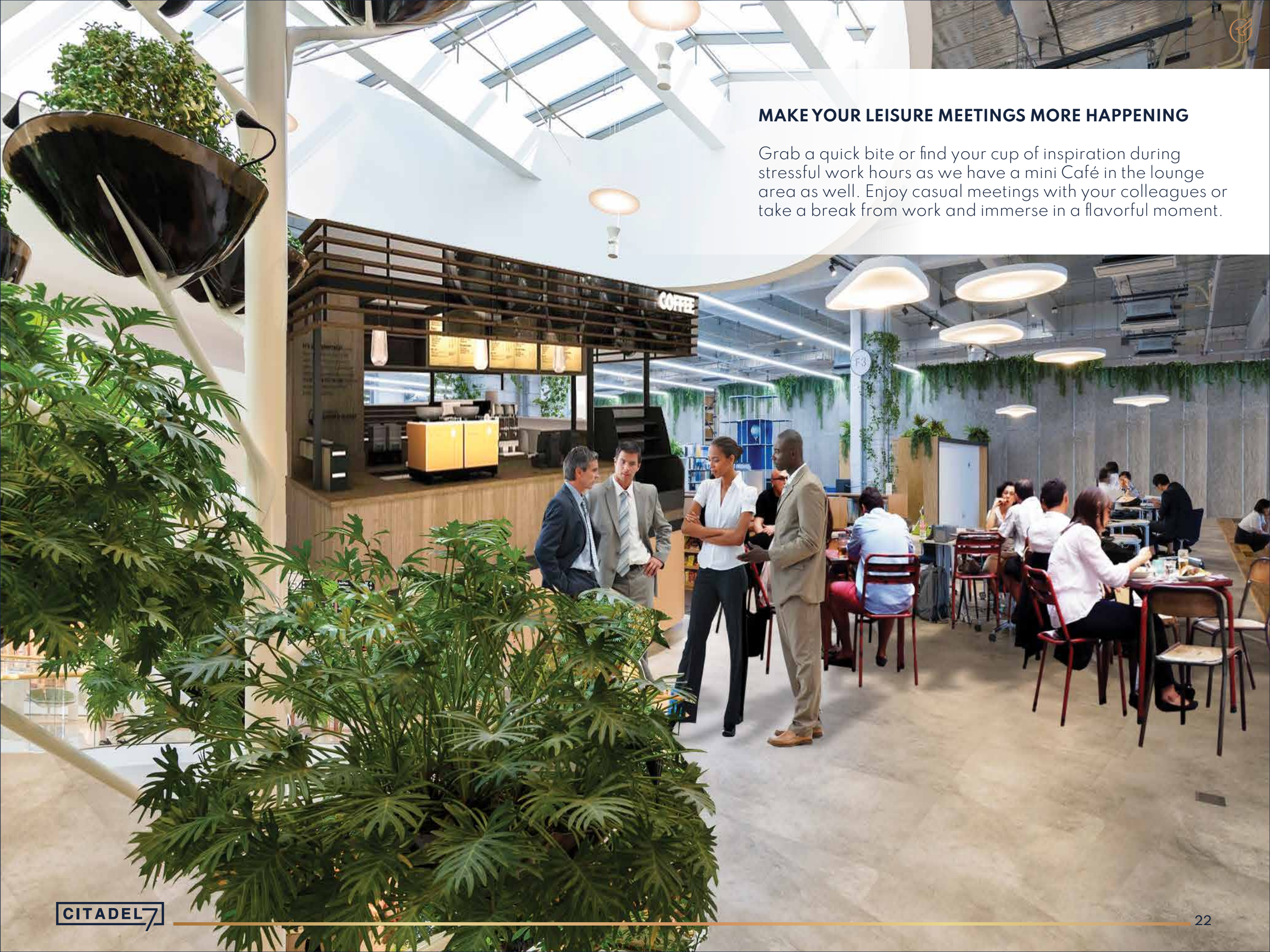

## MAKE YOUR LEISURE MEETINGS MORE HAPPENING

Grab a quick bite or find your cup of inspiration during stressful work hours as we have a mini Café in the lounge area as well. Enjoy casual meetings with your colleagues or take a break from work and immerse in a flavorful moment.



## OFFICE LAYOUT 7<sup>TH</sup>-10<sup>TH</sup> FLOOR



### SUITE #

701	706	711
702	707	712
703	708	713
704	709	
705	710	



## OFFICE LAYOUT 11<sup>TH</sup>-20<sup>TH</sup> FLOOR

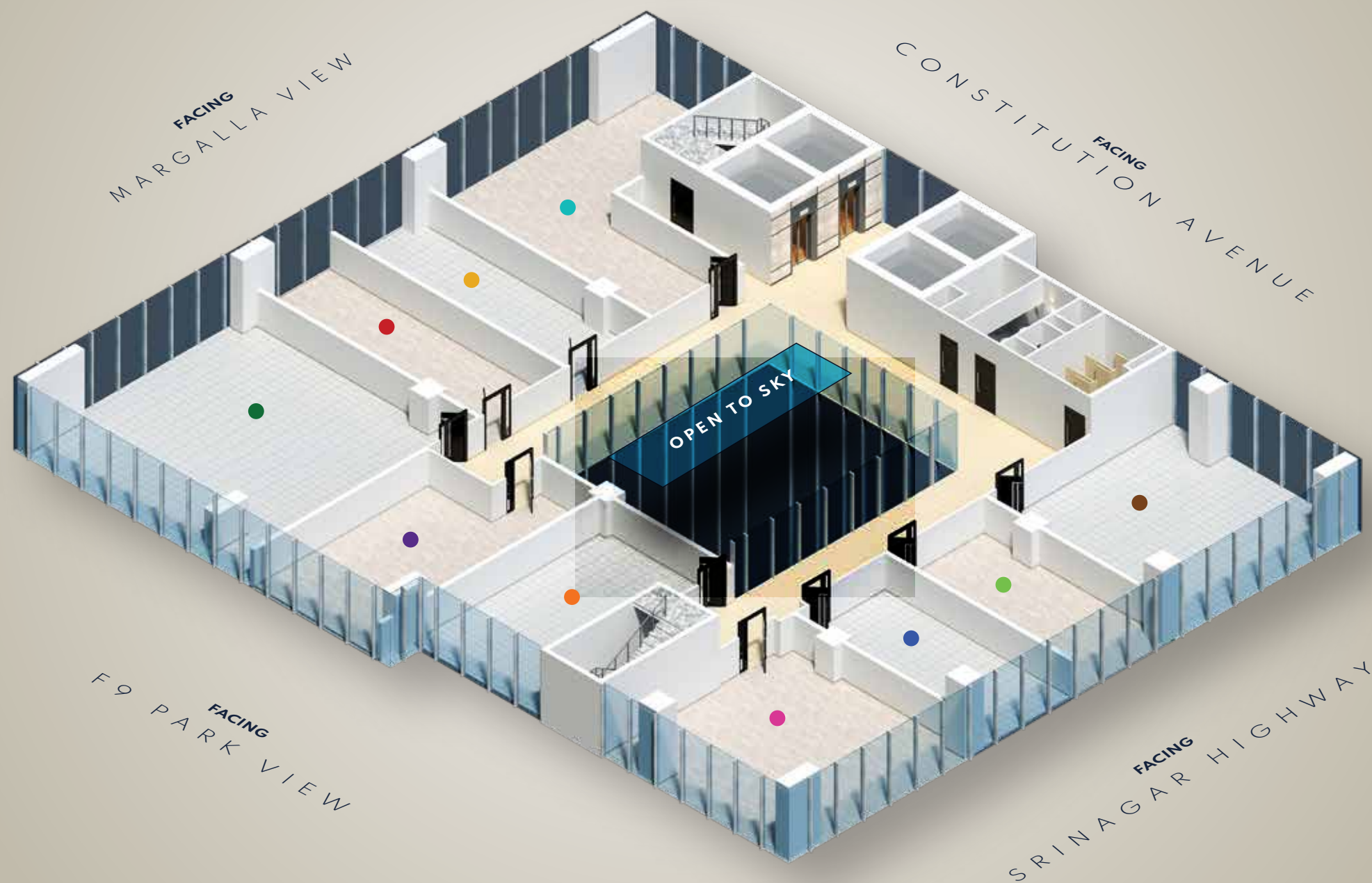

### SUITE #

- |      |      |
|------|------|
| 1101 | 1106 |
| 1102 | 1107 |
| 1103 | 1108 |
| 1104 | 1109 |
| 1105 | 1110 |



## SERVICE FLOOR

# THE HUB OF IT ALL!

**Constantly striving to provide a memorable experience.**

**Citadel 7** offers the best amenities and services with expert management staff. Our service floor is a megastructure floor and the center of all that makes **Citadel 7** stand the test of time.

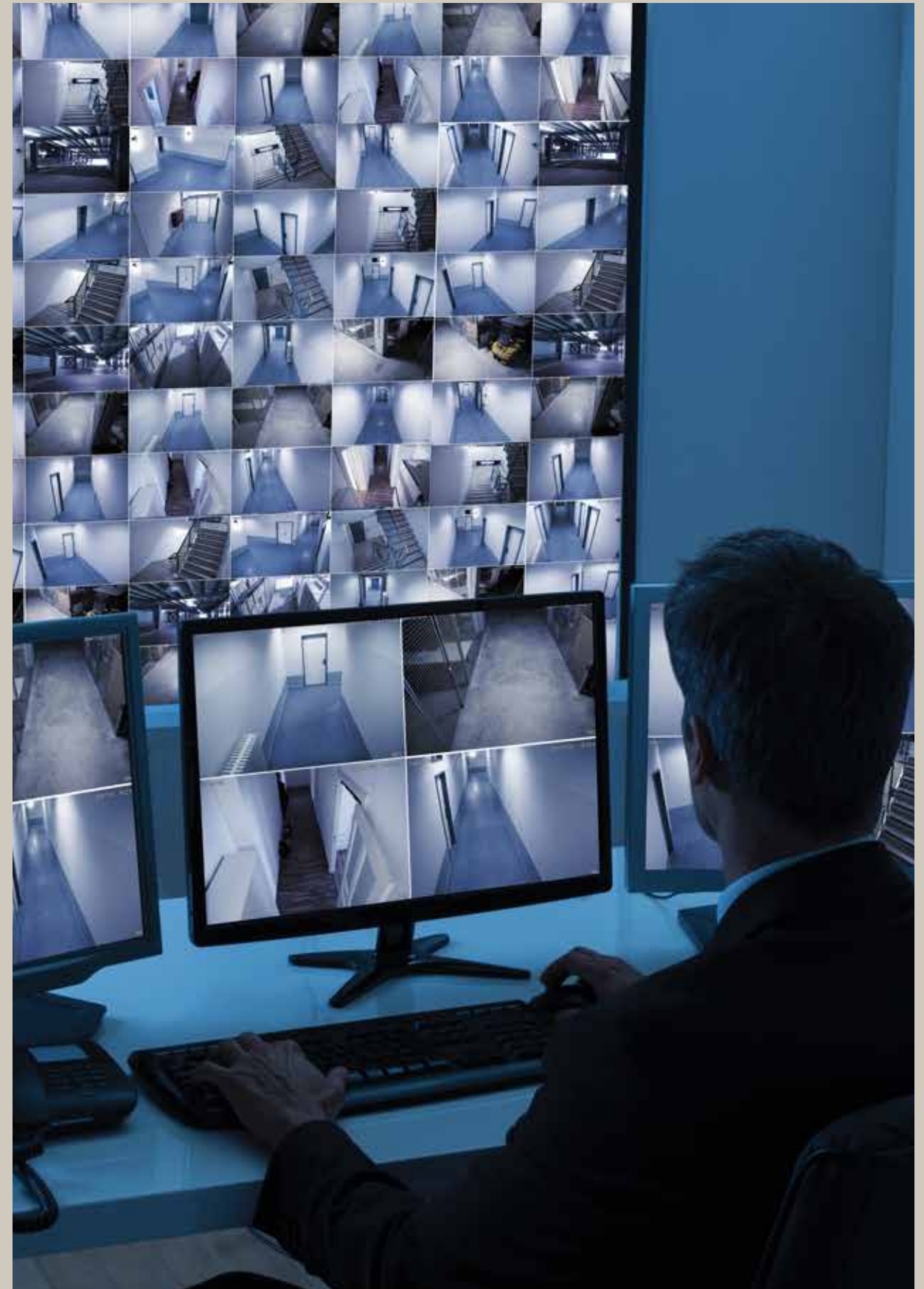

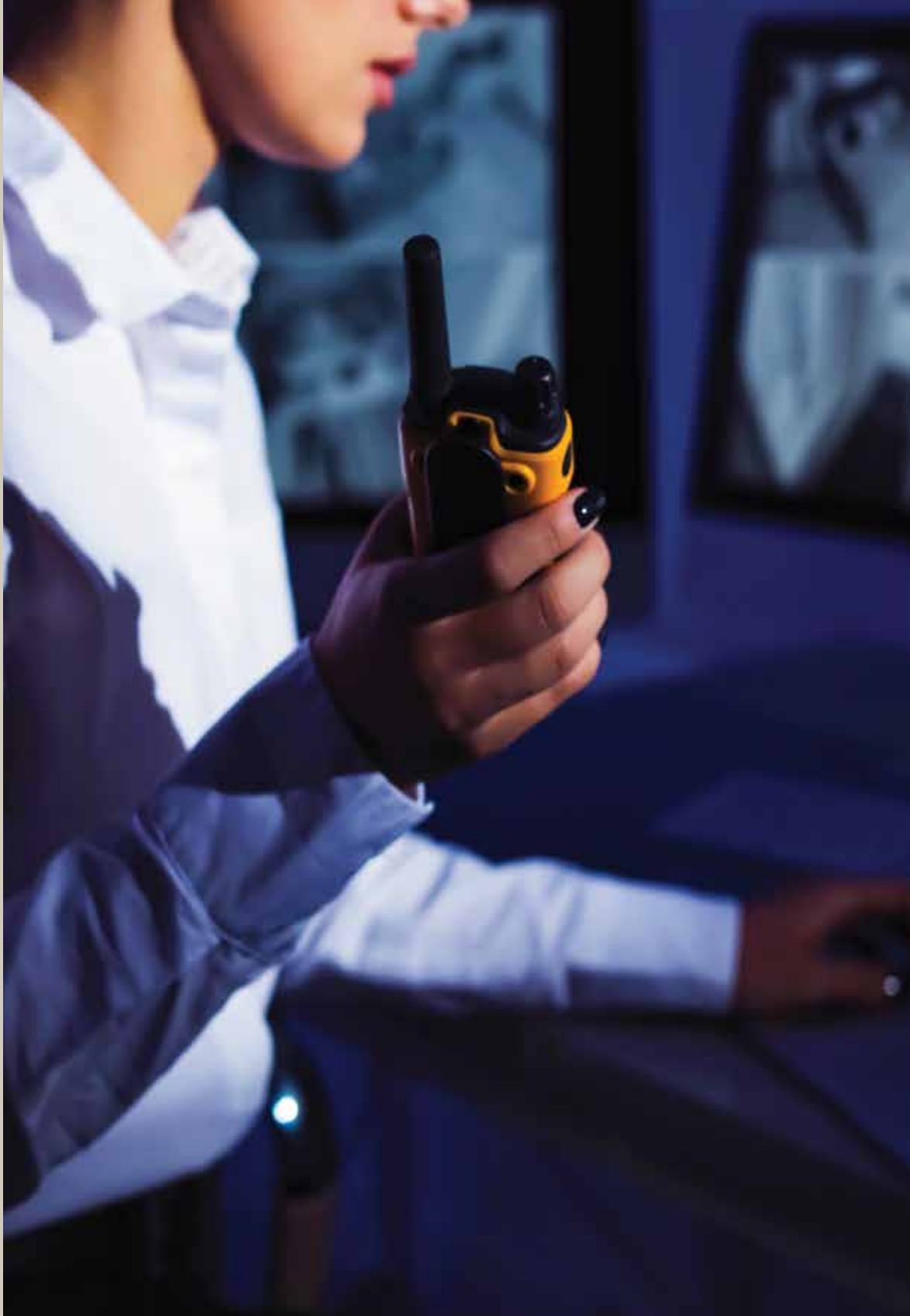

# A SEAMLESS EXPERIENCE

**Equipped with high-tech facilities and smart technologies.**

- IT Center
- Maintenance Floor
- Control Interface Center
- Backup Energy Resource/Power System
- Broadcast/Announcement Room
- HVAC System
- BMS Control Room
- Service Floor for Staff
- Surveillance Room



## FOOD COURT

# FOOD WITH A VIEW

### A quick break to tantalize your taste buds

Our grand Food Court on the 5th level of **Citadel 7** welcomes you to a remarkable ambiance where you can enjoy a diverse culinary experience. Surrounded by glass windows and an outdoor terrace area, you can enjoy the beautiful views of Islamabad while indulging in your favorite cuisines. Choose from a variety of restaurants or treat your taste buds with a plethora of fast-food chains.



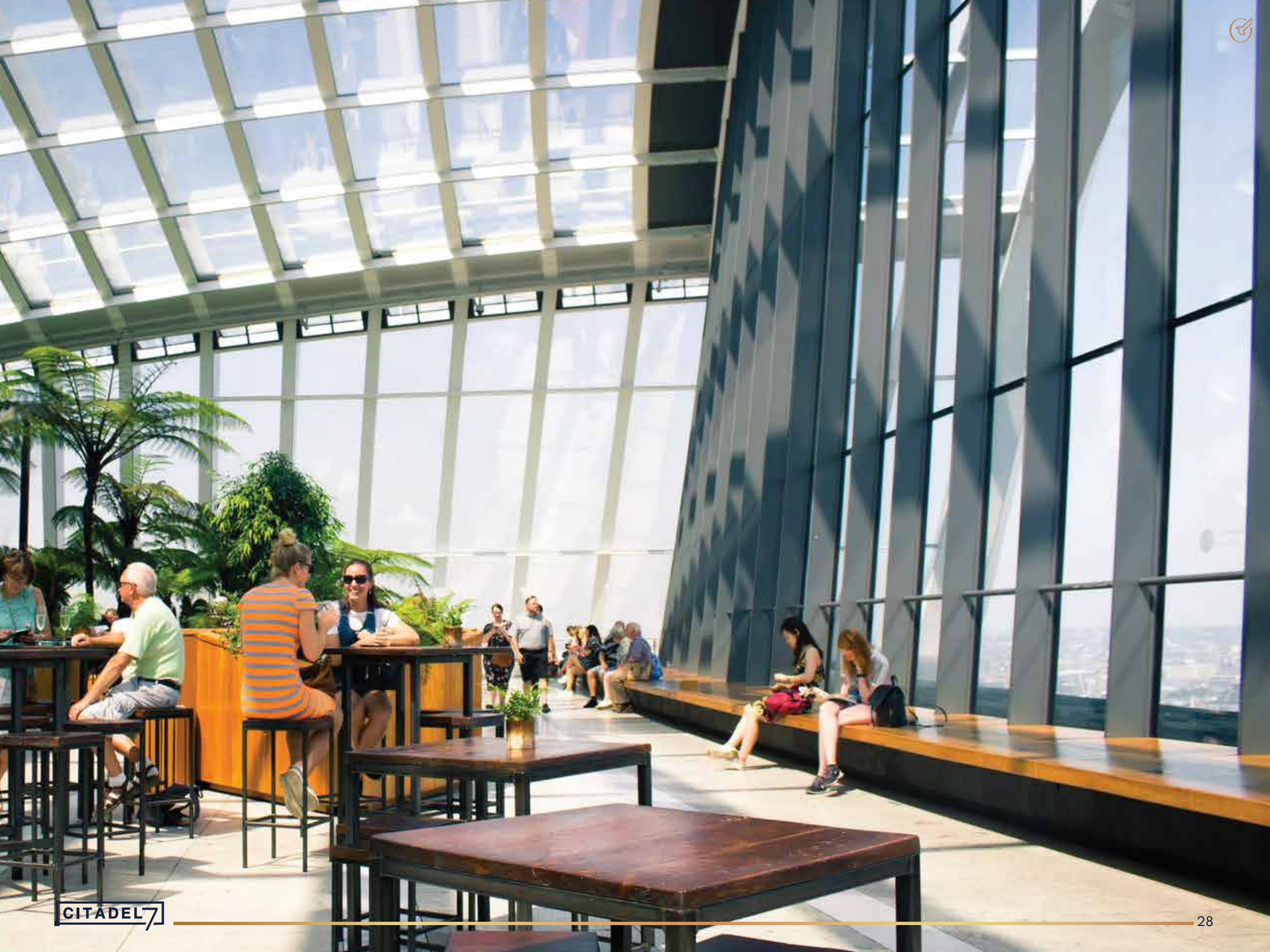



## FINE DINING AN OUTCLASS FINE-DINING EXCURSION

Enjoy an elegant culinary experience with a grand restaurant set amid the 5th floor of **Citadel 7**. Enjoy savory treats with an unparalleled ambiance inside the restaurant or choose to dine out on the terrace where you can enjoy a magnificent landscape view of Islamabad.

**It's a feast for all five senses!**



## CAFÉ

# DELVE INTO A PREMIUM CAFE EXPERIENCE

Our exquisite Coffee Shop located amidst Citadel 7's food court allows you to relax while you indulge in baked French delicacies on the menu. After a shopping spree, opt to settle in with a café au lait or espressos to refresh yourself while enjoying the breathtaking views from our café's terrace area.



## GOOD FOOD GREATER TIME

**Citadel 7**'s outstanding food court caters to all cuisines. At our food court you'll find a range of local eateries, international fast-food chains, as well as a lavish restaurant & café. Enjoy a mixture of formal and casual dine-out experience at the same place.

It is the perfect stop for a meal while you shop.



## FOOD COURT LAYOUT 4<sup>TH</sup> LEVEL





## SHOPPING MALL

# EARN UP THERE SPEND DOWN HERE

Escape in a shopping-infused voyage with **Citadel 7**'s four levels of retail-mall and enjoy an extraordinary shopping experience from top-end brands and international fashion labels under one roof.

With spacious mall concourse and corridors, **Citadel 7** allows you to shop comfortably even during peak hours, no matter how high the footfall is.

## A PINNACLE OF CONVENIENCE

Look up to an impressive atrium that seeps sunlight through immaculate vertical crevices or go beyond your limits with our panoramic capsule elevators that relish a seamless journey.





## AMENITIES

Devoted to excellence with the best services offered



Food Court and Retail



24/7 Surveillance and Secure Facility



Ample Indoor Parking Space



Direct Access from Ibn-e-Sina  
& Jinnah Avenue



Adjacent Parking Lot (CDA Approved)



Optimal Daylight Influx with Atriums



Panoramic Capsule Elevators



Spacious Corridors & Aisles



# CITADEL7

# A VERTICAL MARVEL OF VISIONARY SERVICES

**Citadel 7** has all the essential elements that meet every urbanite's increasing demands and needs. Combining style, innovation, and high-end facilities, we deliver the best retail experience.





## MALL LAYOUT GROUND LEVEL

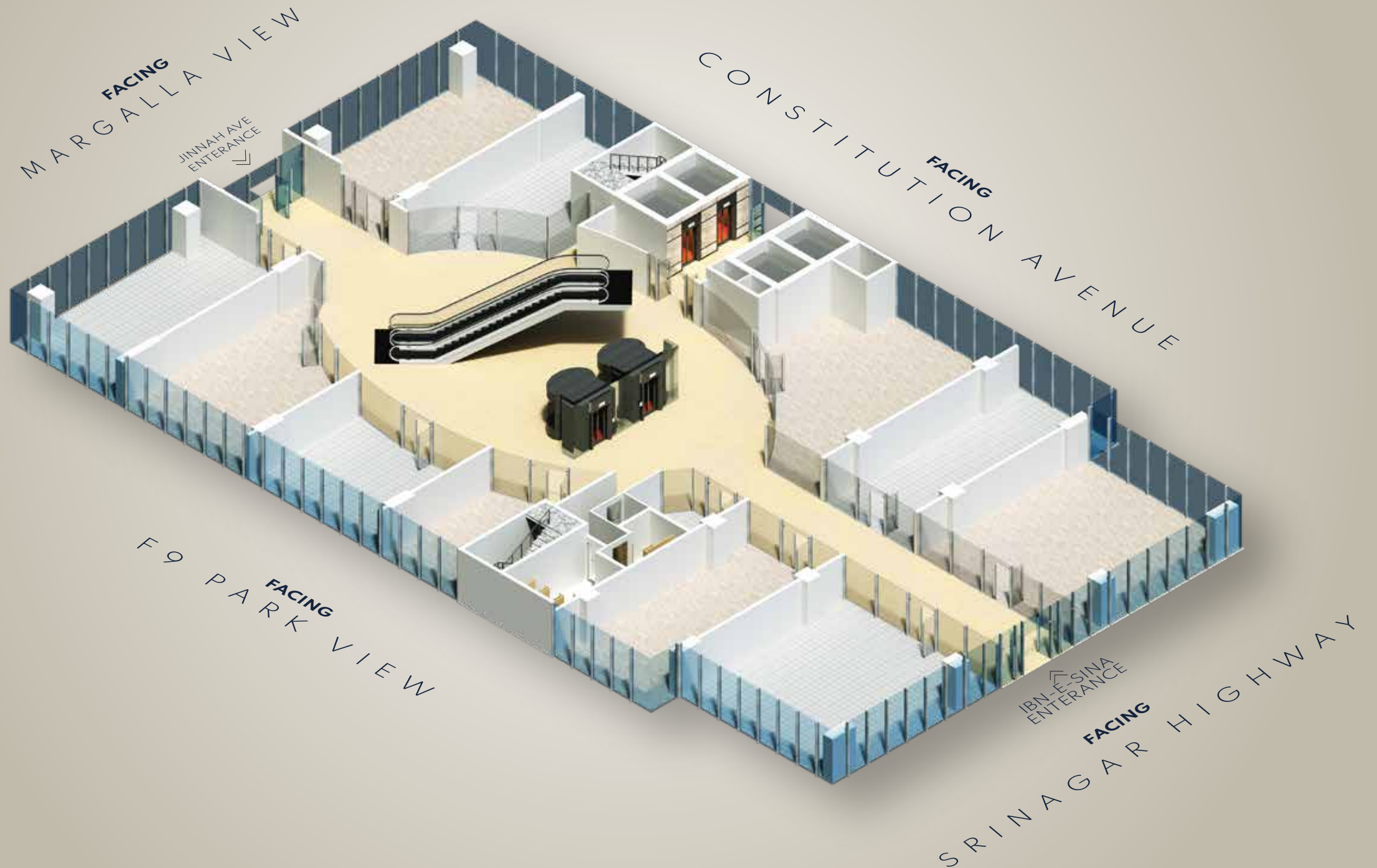



## MALL LAYOUT 1<sup>ST</sup> LEVEL

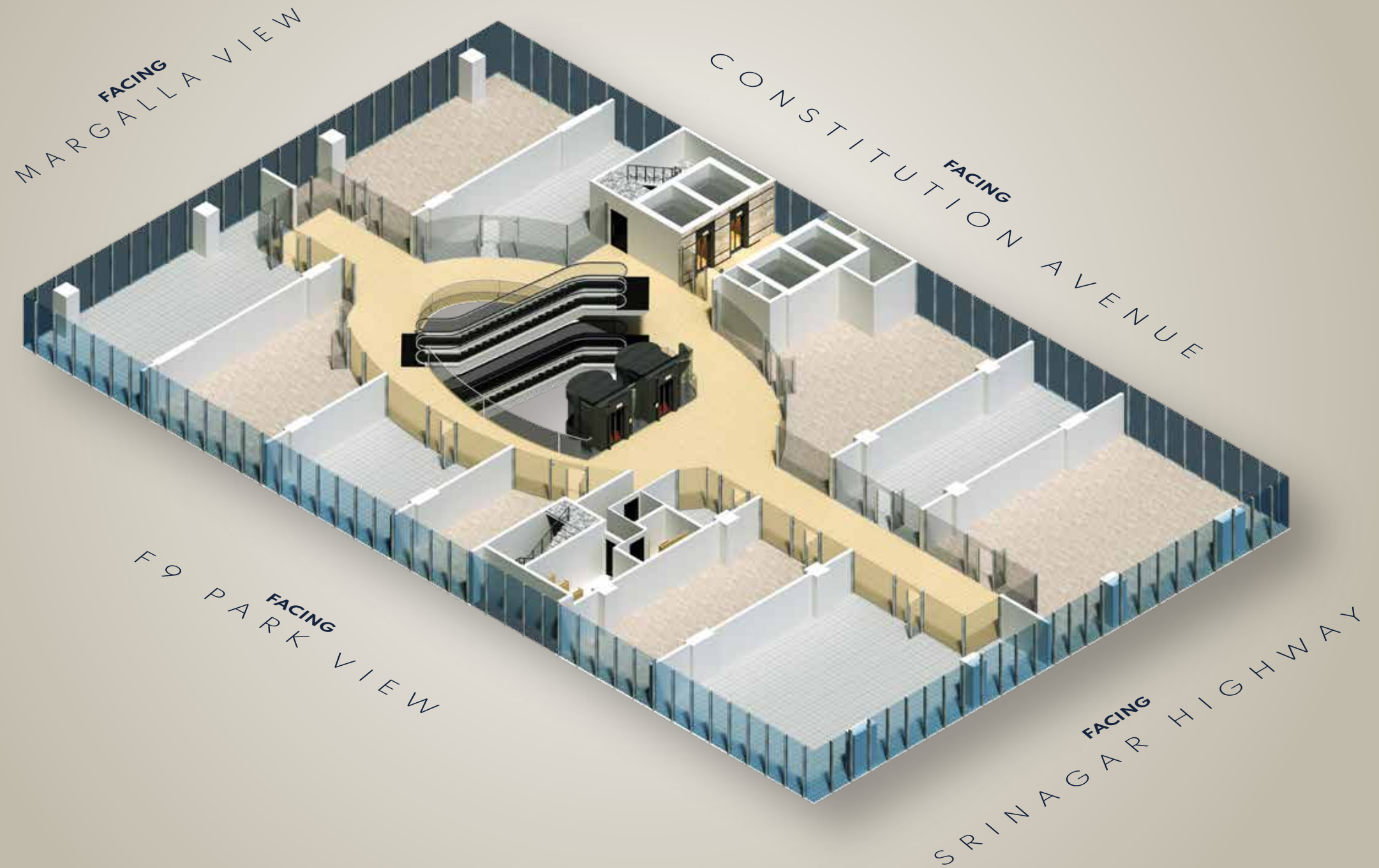



## MALL LAYOUT 2<sup>ND</sup> LEVEL

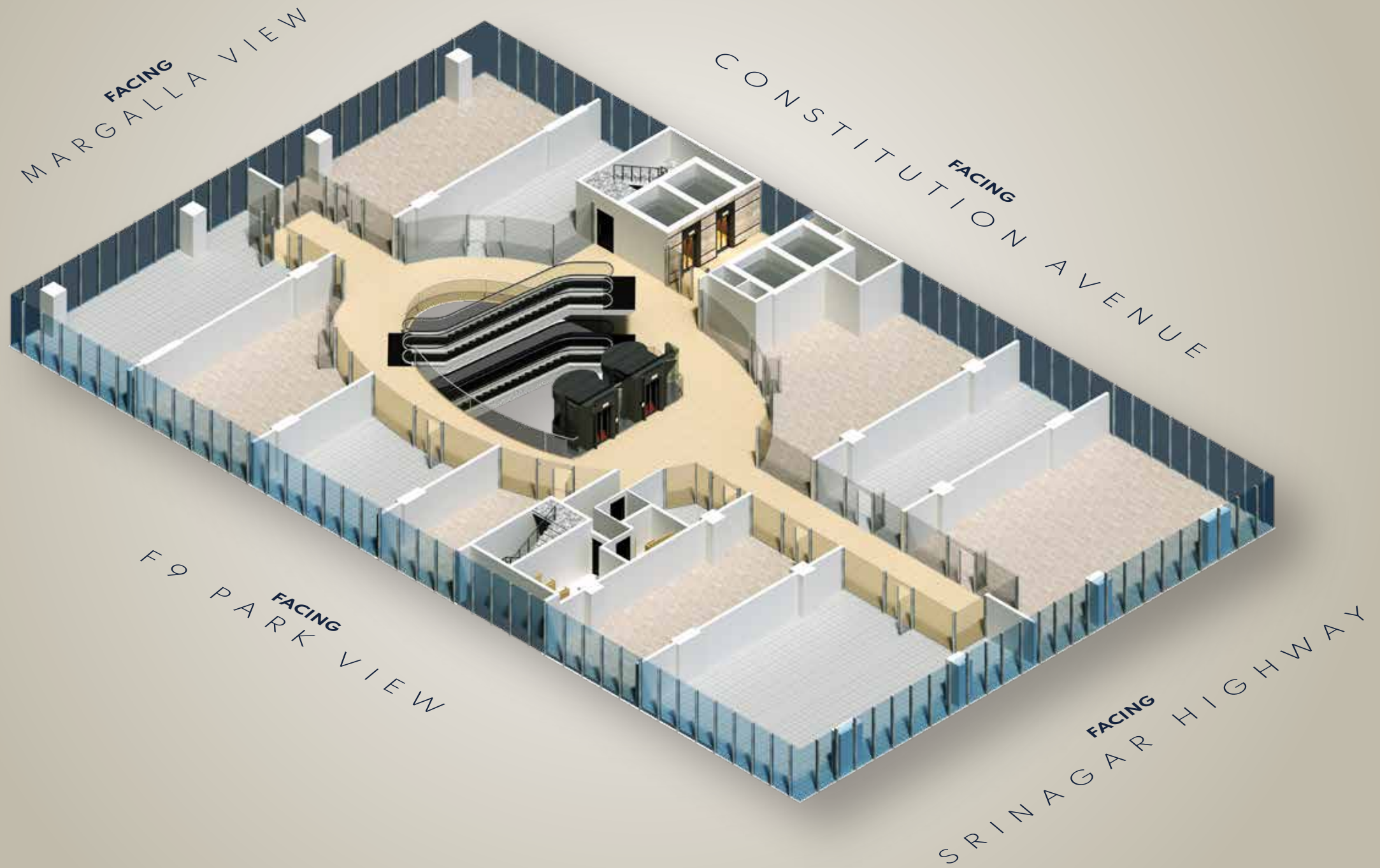



**MALL LAYOUT**  
**3<sup>RD</sup> LEVEL**

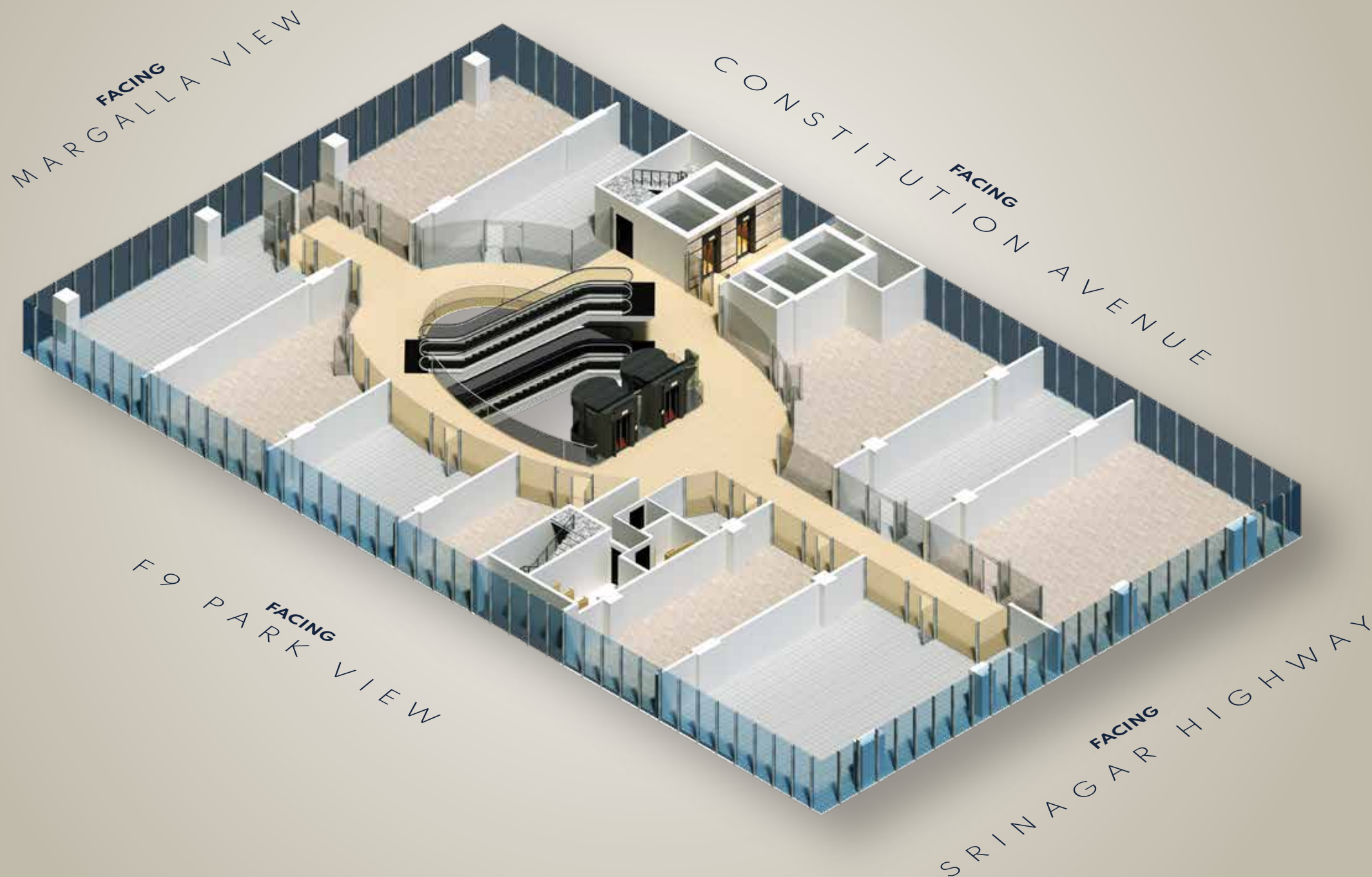



## PARKING SPACE

# A SPACIOUS & CONVENIENT PARKING FACILITY

Park without any trouble with our expansive 4 level basement parking area. Leave the hassle of finding the space as we feature indoor and outdoor parking spaces that can accommodate a plethora of vehicles.

- Hybrid Spacious Parking Space
- Dedicated Space for Offices.
- 4-Level Basement Parking.
- Expansive Outdoor Parking (CDA Approved)

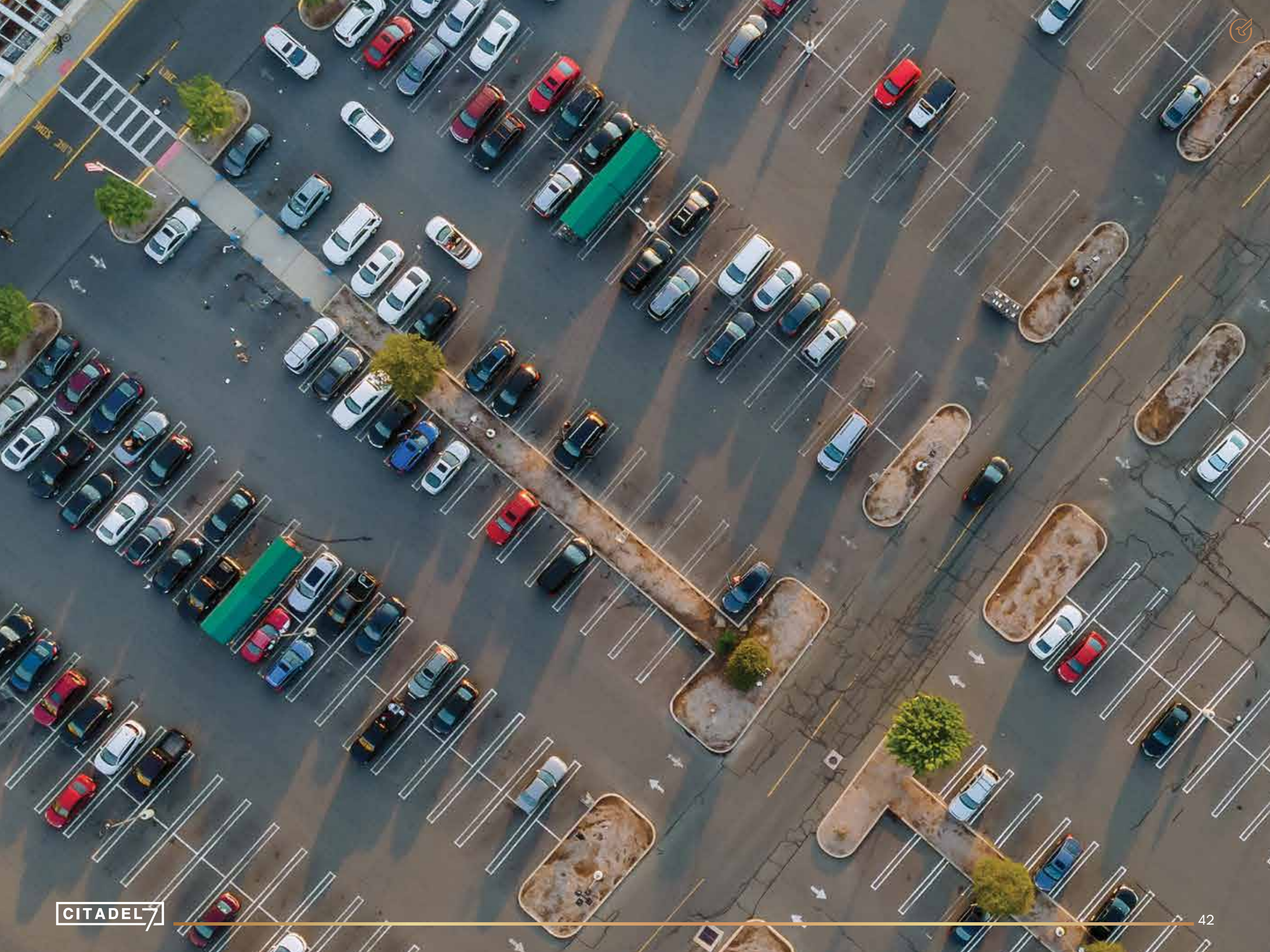



# VIEWS FROM CITADEL7





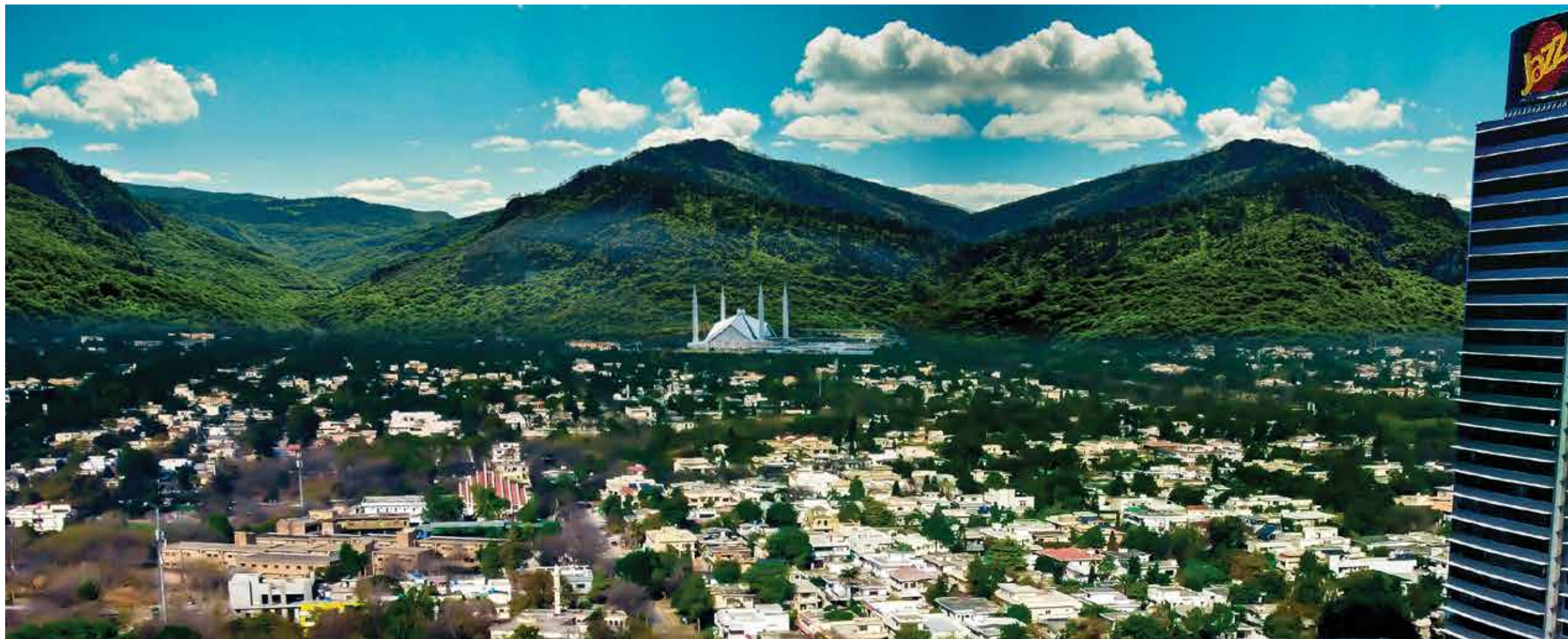



JINNAH AVENUE, BLUE AREA

A PROJECT BY



Citadel 7 Site Office, Main Jinnah Avenue, Blue Area, Islamabad.  
[www.chakorventures.com](http://www.chakorventures.com) | [sales@chakorventures.com](mailto:sales@chakorventures.com) | +92 334 1111199

STRUCTURE & DESIGN PARTNERS



SINGAPORE PVT LTD | PAKISTAN PVT LTD

MARKETING PARTNERS



TEXAS, USA | KARACHI, PAKISTAN

FIND US ON  
GOOGLE



LEARN MORE

